

**Standard floor plan
3 Car garage**

**2543 Sq. Ft.
693 Sq. Ft.**

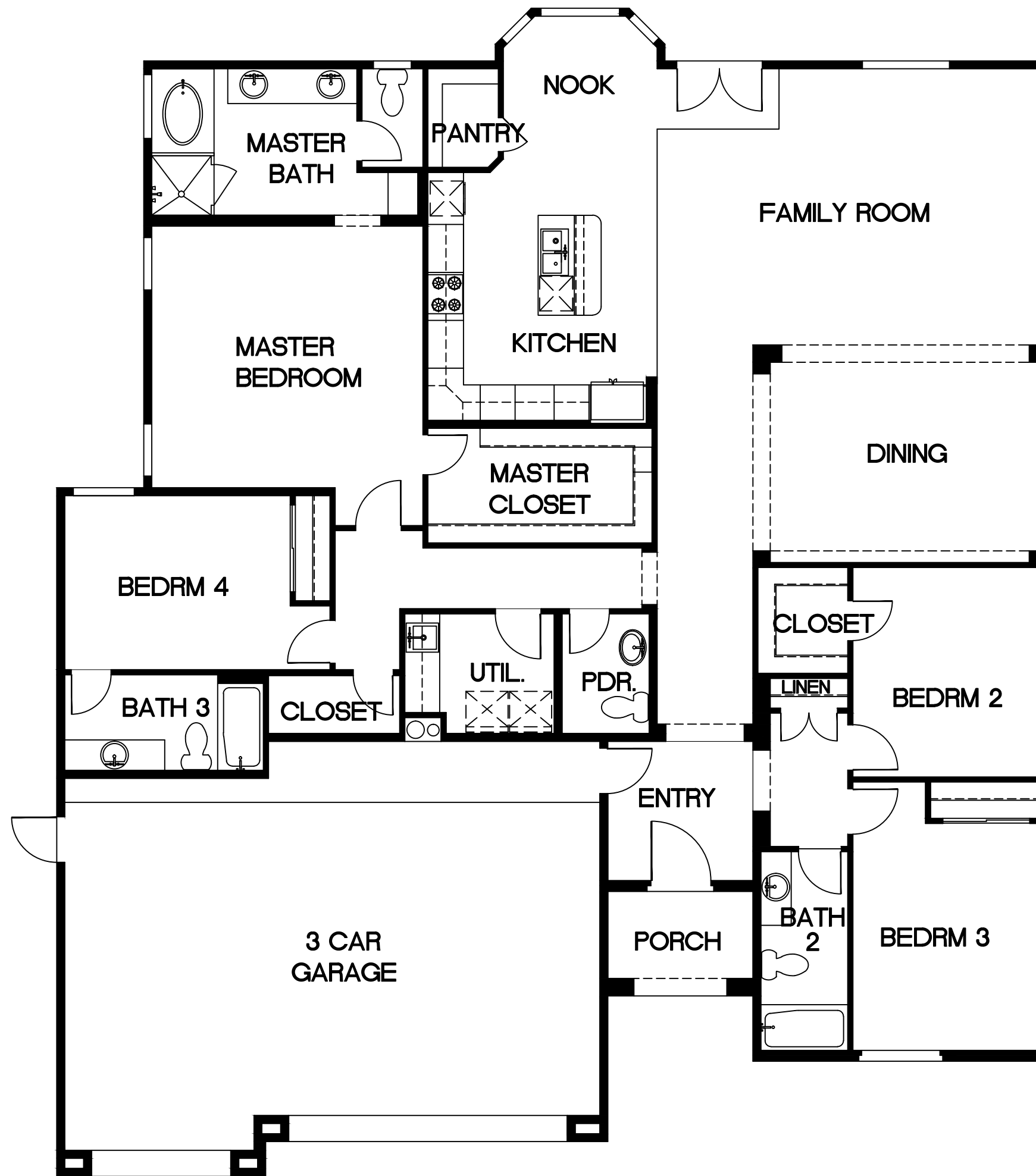

Options Available

- | | |
|---|--------------|
| 1. Covered Patio | 335 Sq. Ft. |
| 2. Bedroom #5 with bath #3 | 2789 Sq. Ft. |
| 3. Solid Wall | |
| 4. Fireplace | |
| 5A. Home within a home w/4th bedroom | 2789 Sq. Ft. |
| 5B. Home within a home w/5th bedroom | 2789 Sq. Ft. |
| 5C. Home within a home w/5th bedroom, bath 3, powder room | 2875 Sq. Ft. |
| 6A. Double sink in bath 2 | |
| 6B. Double sink in bath 3 | |

RESIDENCE 6 STANDARD FLOOR PLAN